

PRODUCT ID: 1790

Angle Mount Bracket

MODEL

DAM1026-30/45

DIMENSIONS

10" H x 26" W x 12" D (est. 7.03 lbs)

CONSTRUCTION

Finish: Duranodic Bronze

Material: 1/8" thick aluminum; single bracket has both 30° and 45° angles

INSTALLATION

Note: Sign Mounting Angle: 30°/45° dual angle

Product View

NOTE: Sign image may not exactly represent the finished product. For illustration purposes only.

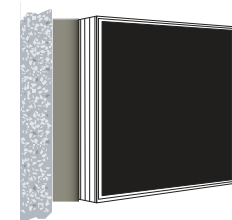
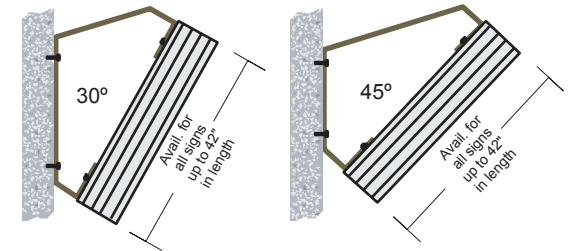
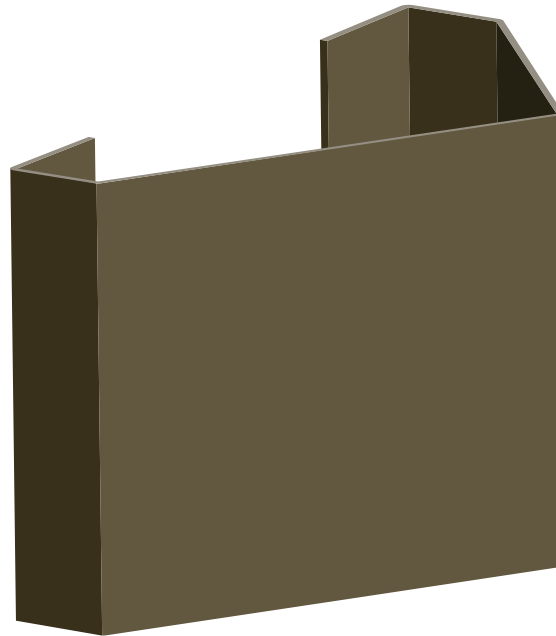

Directional Systems

2201 W 50th St.

Erie, PA 16509

Phone: (877) 827-8296

Fax: (877) 827-8291

Email: sales@directionalsystems.com

Website: www.directionalsystems.com

Directional
Systems