

# PRODUCT ID: 21634

## Mast Arm Post

### MODEL

MAP120B12

### DIMENSIONS

120" H x 108" W x 12" D (est. 65.12 lbs)

### CONSTRUCTION

Finish: Duranodic Bronze

**Horizontal Post:** 2.25"x3" post with one sign mounting channel and one end cap. Supports up to 6ft long Clearance I-Bar.

**Structural Gusset:** 18"h x 18"w x 3/8"d aluminum plate; one side welded to upright post, extruded "T" mounting welded to the top. Horizontal post slides onto mounting and is secured in place with bolts.

**Upright Post:** 4" x 4" fluted extruded aluminum post with a sign mounting channel on each side, one mounting rail extrusion, one end cap and 12"x12" welded base plate. Base plate is a 3/8" aluminum plate with pre-drilled anchoring holes and 4-4" high welded gussets.

## Product View

NOTE: Sign image may not exactly represent the finished product. For illustration purposes only.

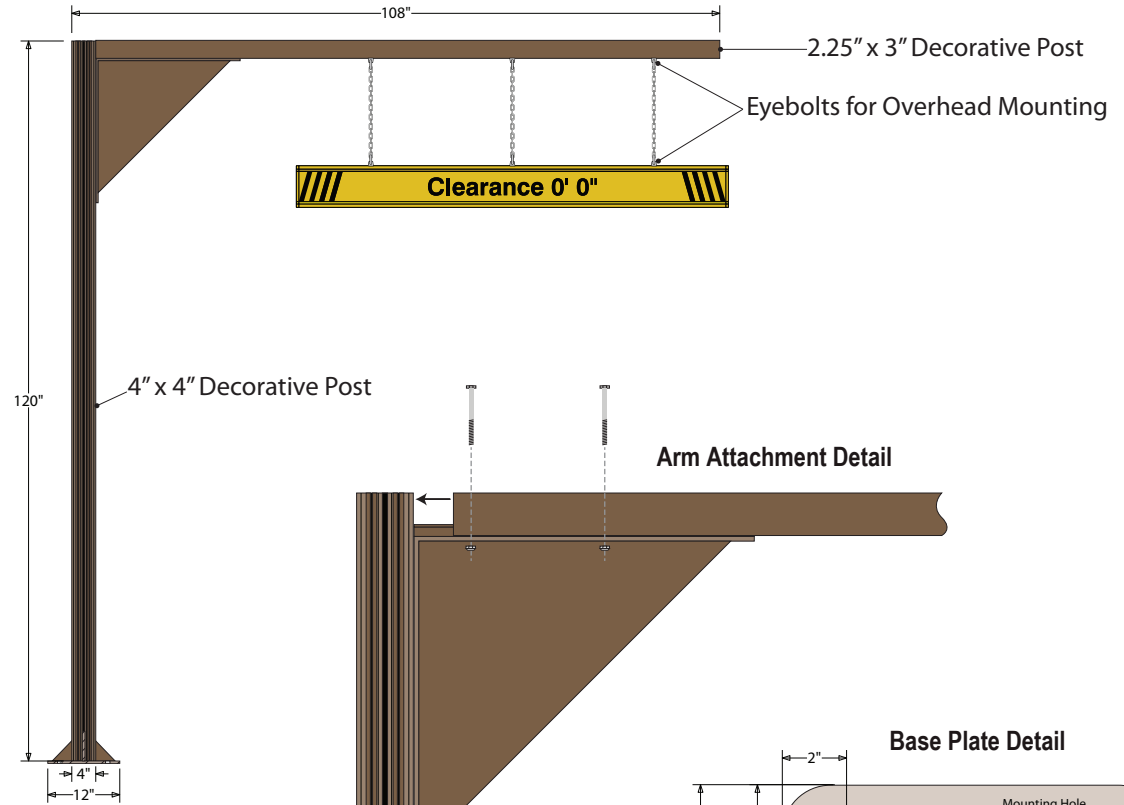

### Arm Attachment Detail

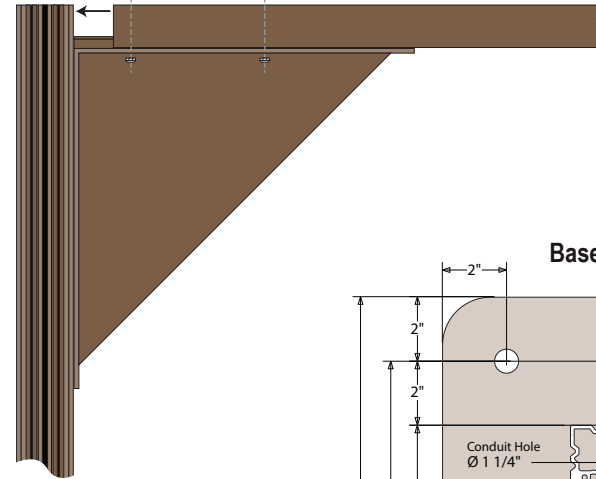

### Base Plate Detail

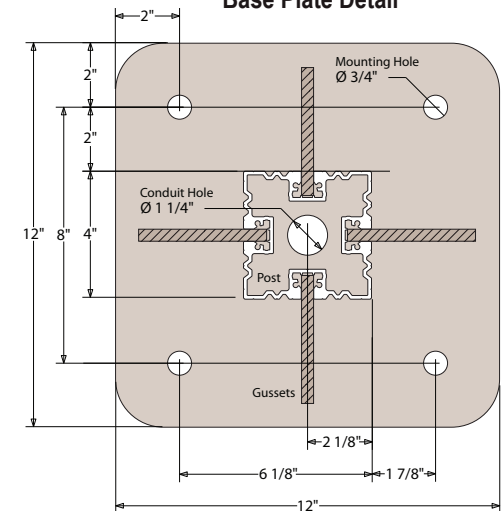

### Directional Systems

2201 W 50th St.

Erie, PA 16509

Phone: (877) 827-8296

Fax: (877) 827-8291

Email: [sales@directionalsystems.com](mailto:sales@directionalsystems.com)

Website: [www.directionalsystems.com](http://www.directionalsystems.com)

**Directional**  
Systems